

Territorial Strands

Our proposal stems from reinforcing the existing natural and urban corridors to improve the connectivity between the Twin-Town through three distinctive strands:

Green strand. The recovering of the creek area as a central Park, connecting the new core of the conurbation to the Pedele-Pedeli River as well as improving the accessibility between both margins of the stream.

- Grey strand. A reinvented urban axis that relates main public spaces of both sides of the border.

- Brown strands. New pathways parallel to the Pedestrian Street on the Valka side, arranging a new Plaza for multiple events in addition to the bus terminal. The itinerary of these lines infl ects and turns once entering into the green space of the creek. Some pathways create the limits of the green area; other trails bridge over the creek, whereas some others meet existing paths in order to reach the fluvial space.

Each colour defines a specific urban element with diverse roles in terms of use of the public space.



Green Strands: the park

- Fluvial green
- Creek park
- Green filters
- Urban greens



Increase local green Oak



Alder



Aspen



Amphitheater



Green Filters



Permeable pavements

Grey Strand: urban axis

- Granite cobblestones
- Concrete pavers
- Mix concrete and green Permeable pavements



Concrete pavers



Mix pavements



Cobblestones

Brown Strands: pathways

- Footbridge

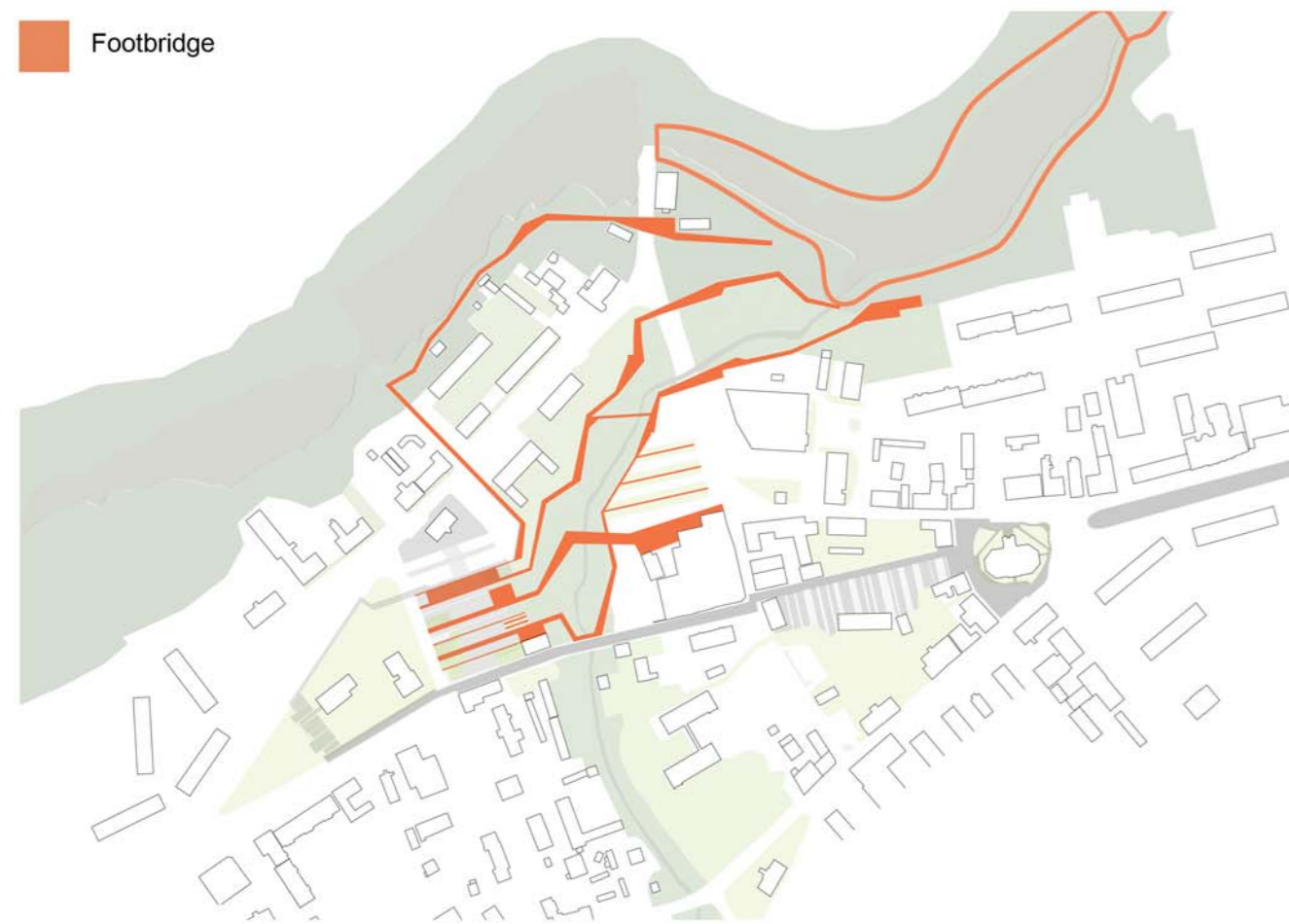

Wood paths



Integrated furniture



Picnic areas



Brick paved paths



Elevated timber footbridge

Hot spots: emblematic elements

- Singular buildings. Reconstruction
- Border points
- New cultural facilities

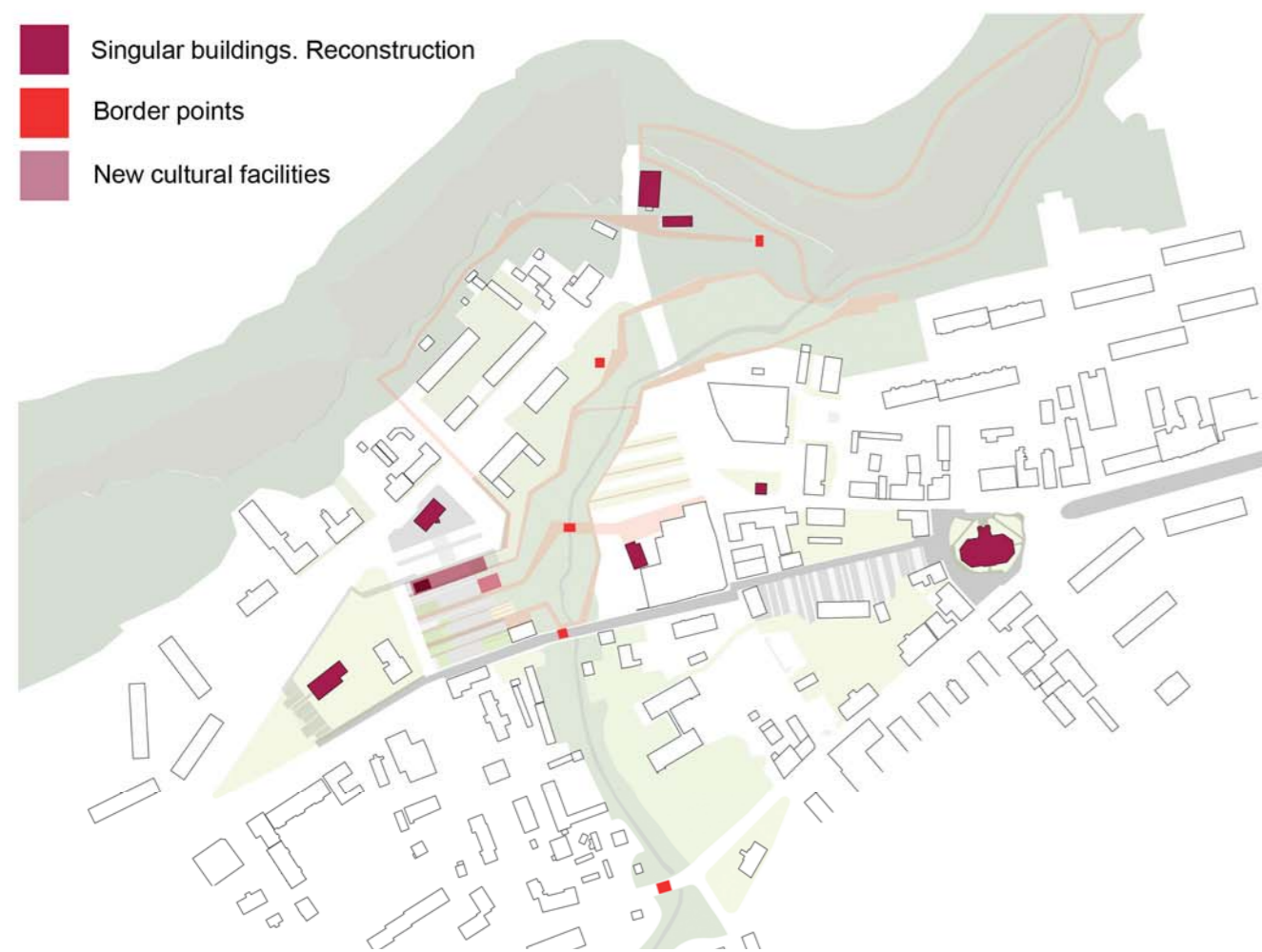

New cultural center



National geographic point



Market shed



Ramsi watermill services building



Border points



Kiik

Urban Interventions

We propose to break down the interventions into various scenarios. These prospects are not necessarily in chronological order, but are differentiated in various urban elements that can be executed independently or in other sequences depending on the future needs.

Prospect 1:

- Demolition of existing obsolete buildings and outbuildings of the apartment houses.
- Development of the Pedestrian Street along Raina-Sõpruse.

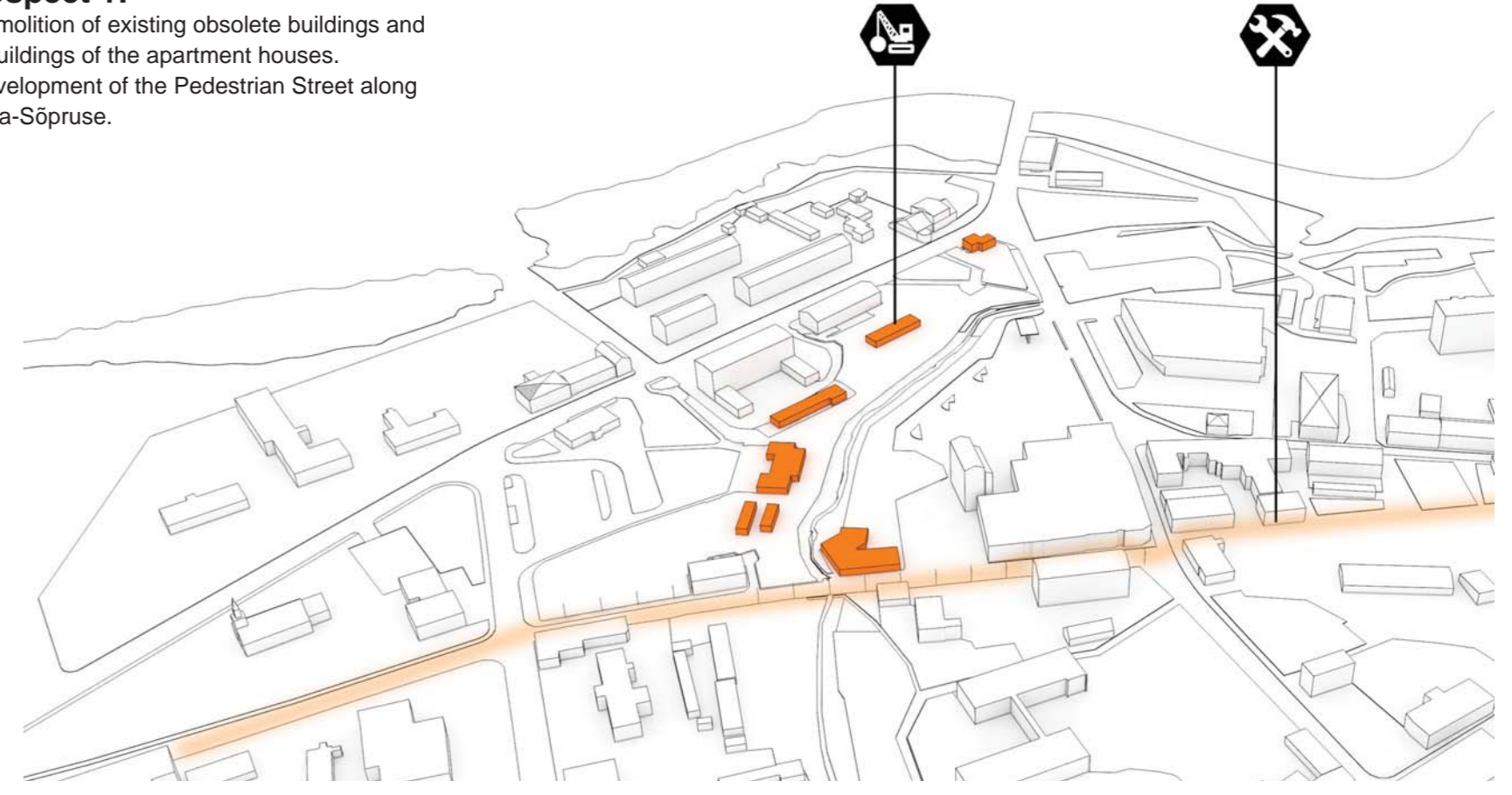

Prospect 2:

- Construction of new storage buildings for residents.
- Development of the new plaza with the redesign of the Valka bus operating area.
- Construction of the two new perimeter pathways of the Creek park.
- Restoration of the former Ramsi Watermill as a new service point and restaurant.
- Relocation of National Geographic's frame.

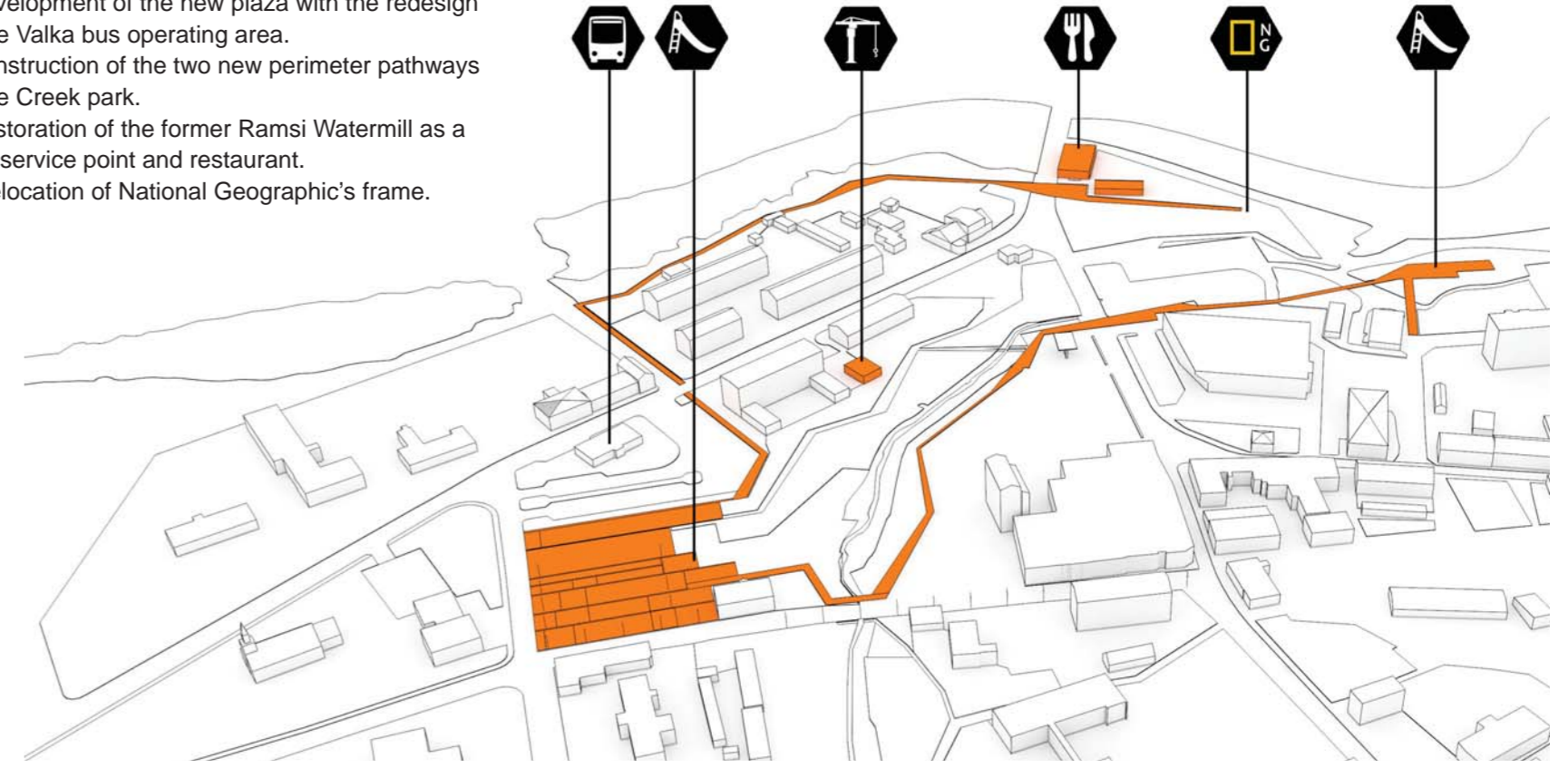

Prospect 3:

- Construction of a new market shed.
- Construction of the two central pathways of the Creek Park, which bridge over the border to create a new elevated platform connecting the Twin Towns.
- New wood open stage that articulates the new Plaza and the Creek Park.
- Restoration of the old Winery tower into a new cultural space and restaurant.

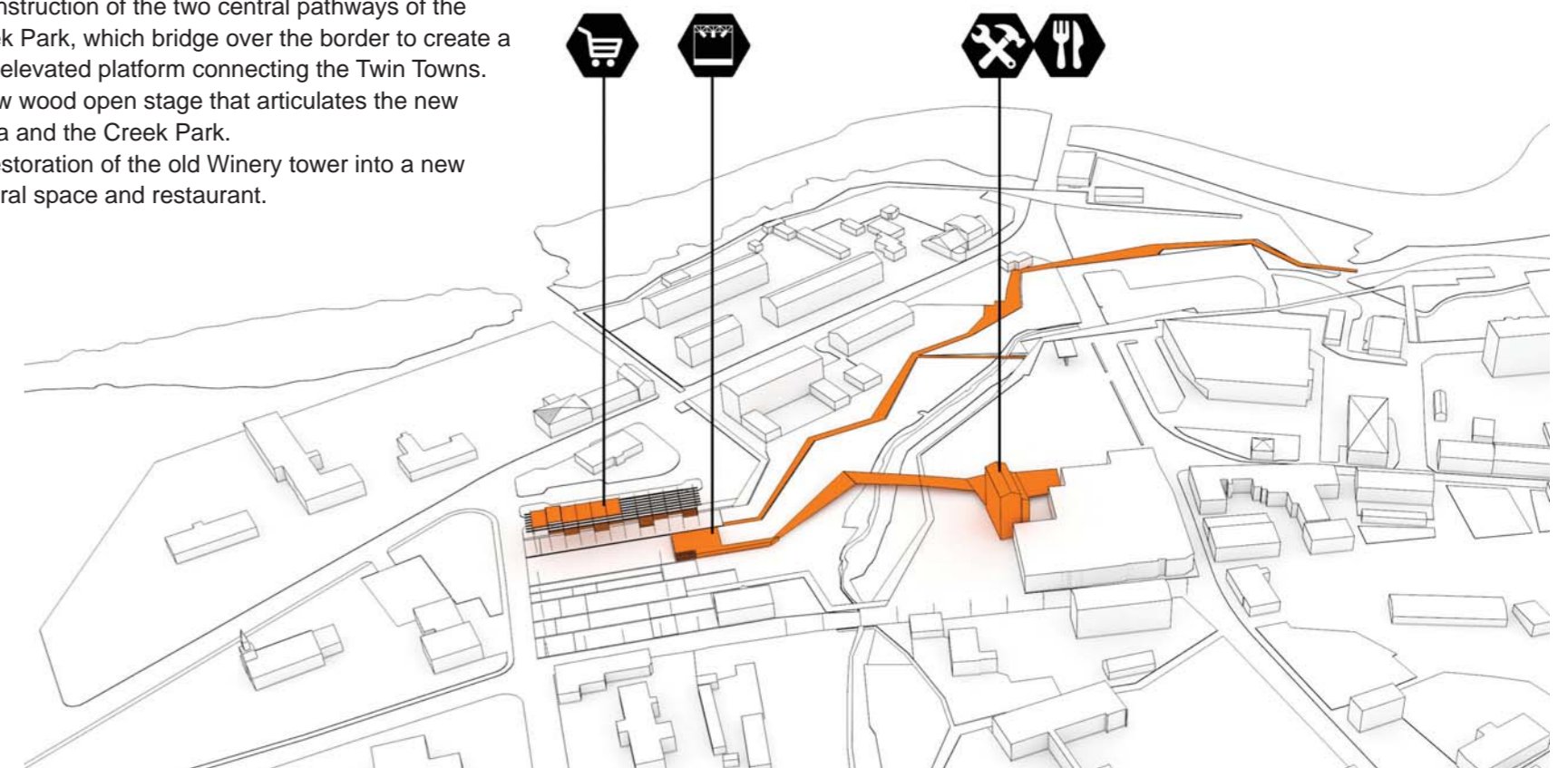

Prospect 4:

- Construction of new multifunctional building under the pergola, with further extension if needed.
- Imaginable future small local businesses along Raina-Sõpruse and the new Plaza.
- Future extension of Selevor shopping center.
- Development of the Creek Park with new furniture, outdoor lounges and sports infrastructures for leisure activities.

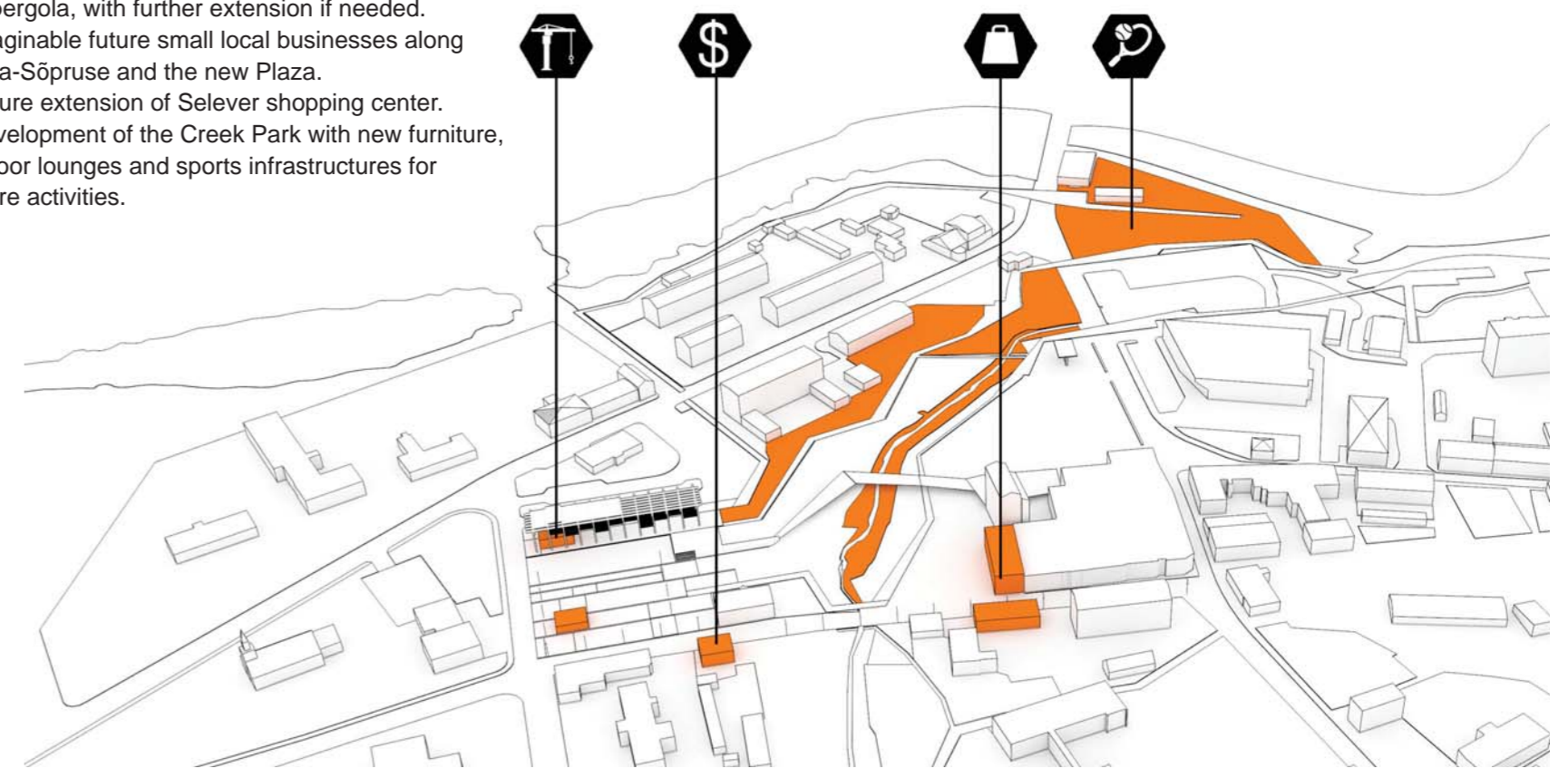

Crossing the Border

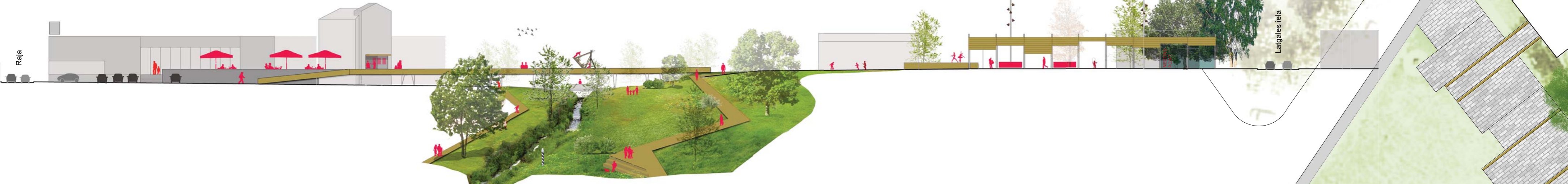





Mobility plan

- Max. speed: 50 km/h
- Lanes of traffic: max. 2
- Bus path and truck path
- Pedestrian area priority
- Bike path
- Car parking area

Street Lighting

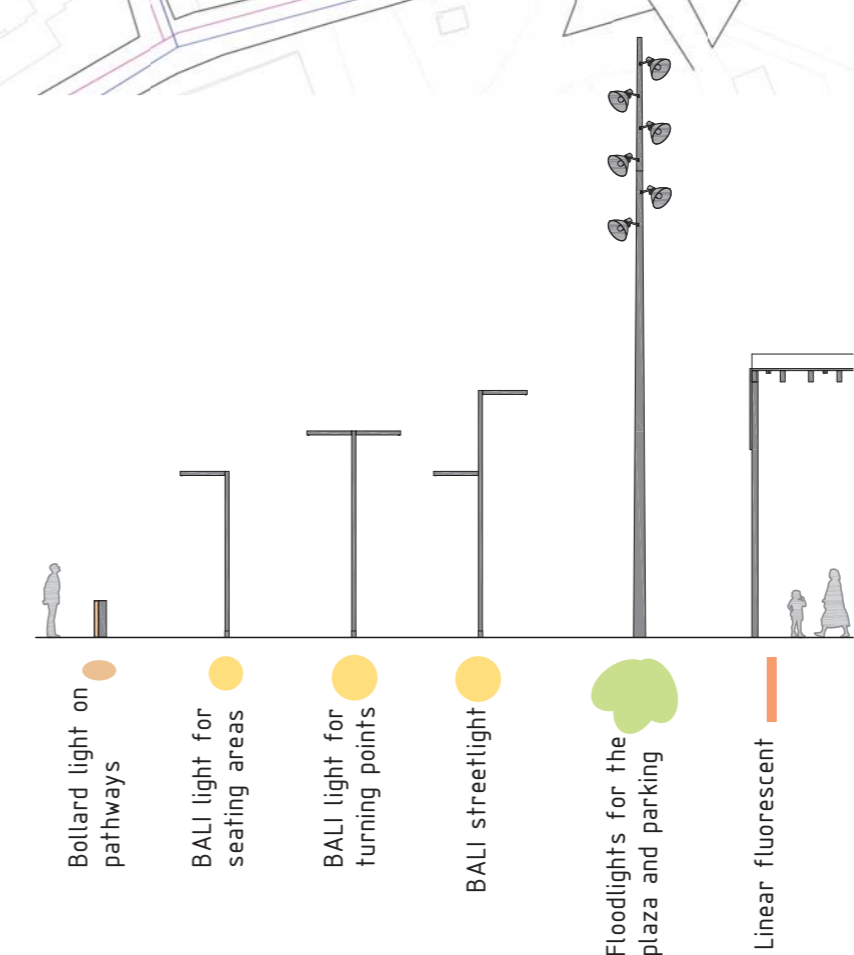

Versatility of the Plaza

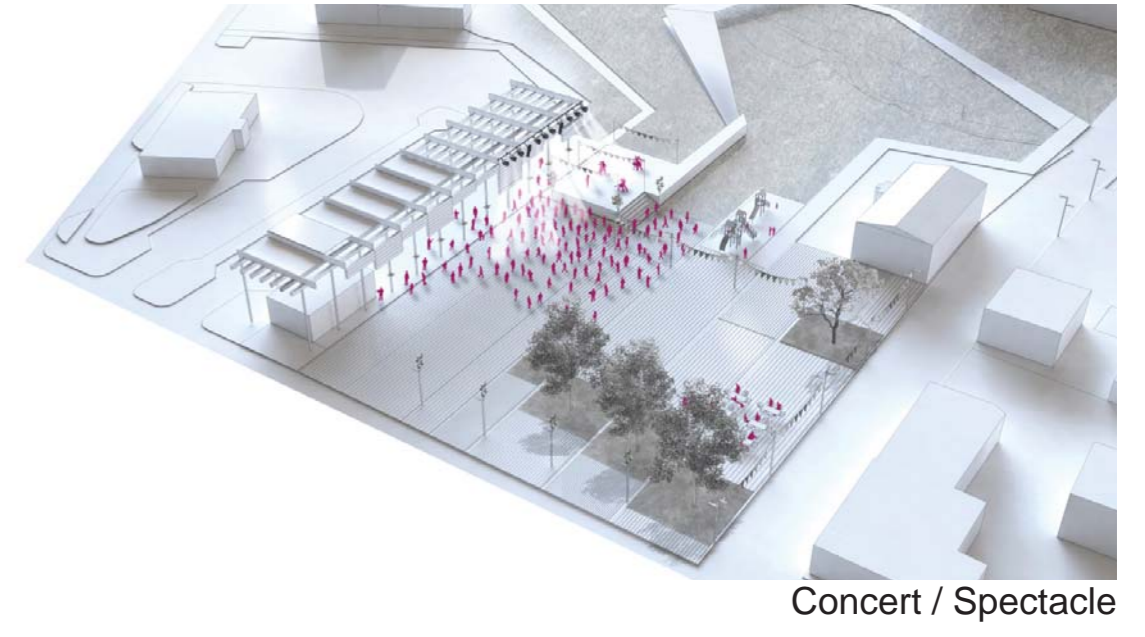
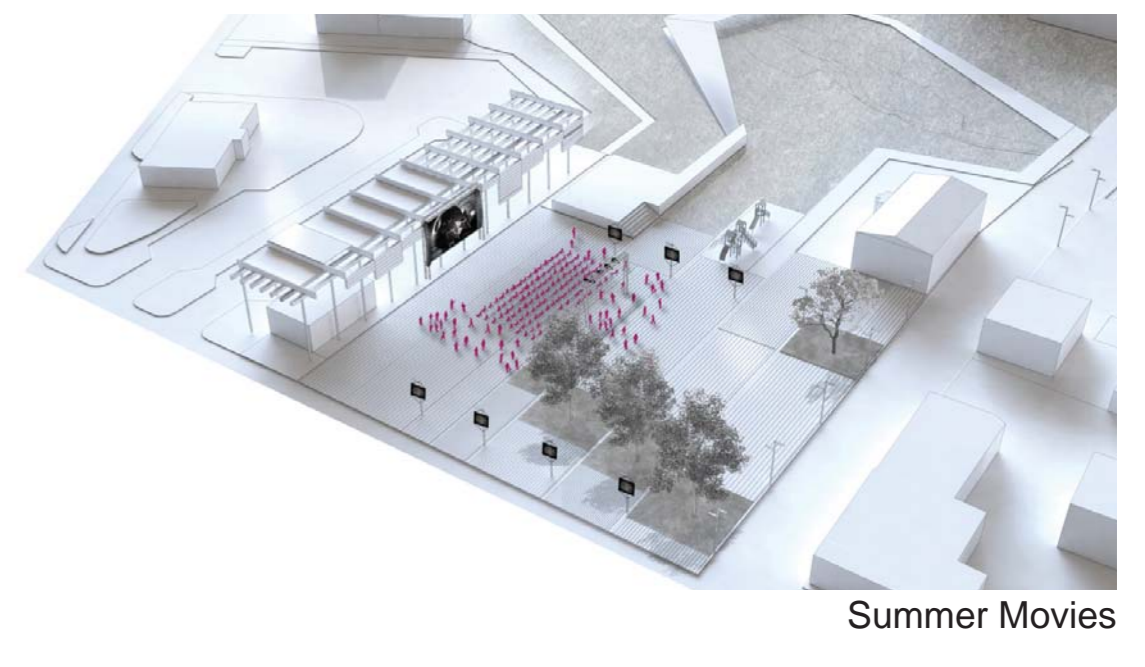
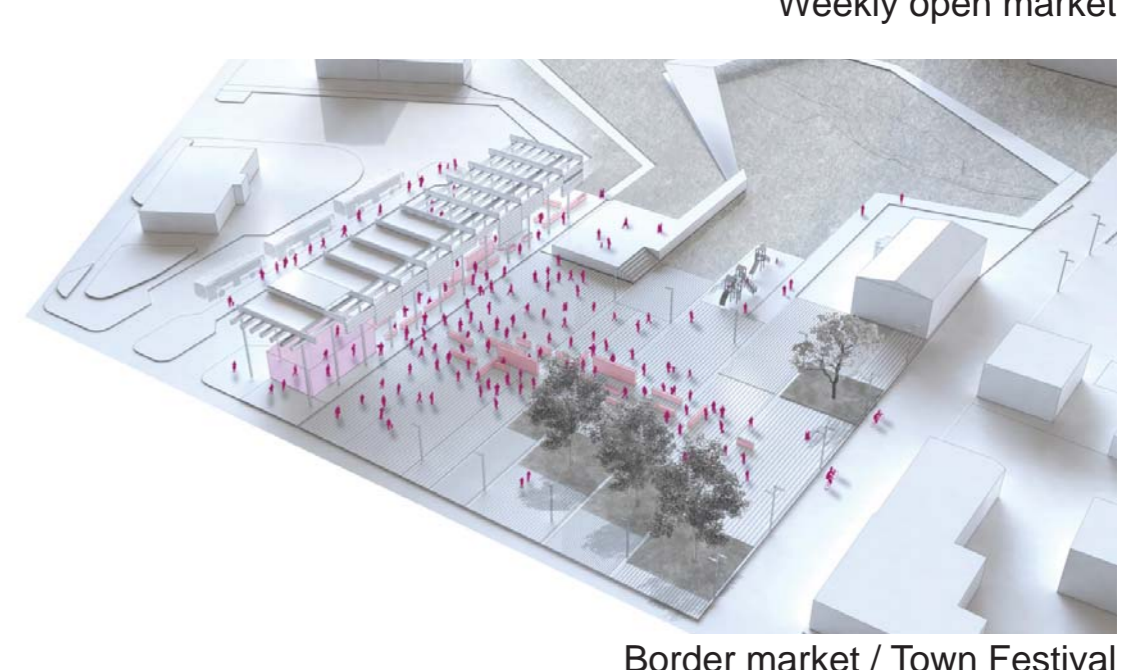
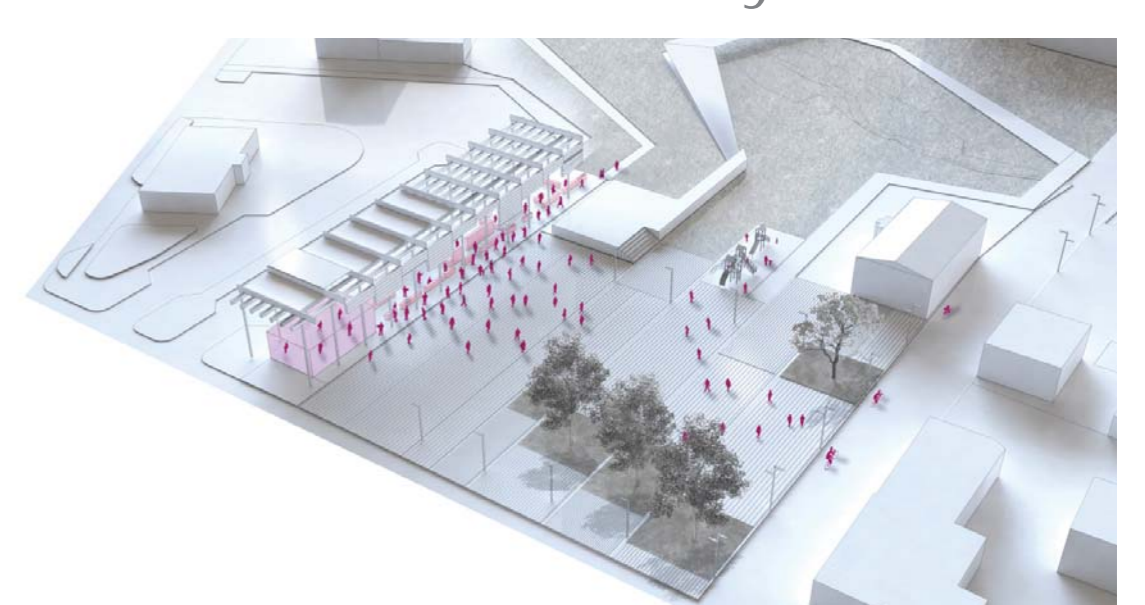



Pavement details

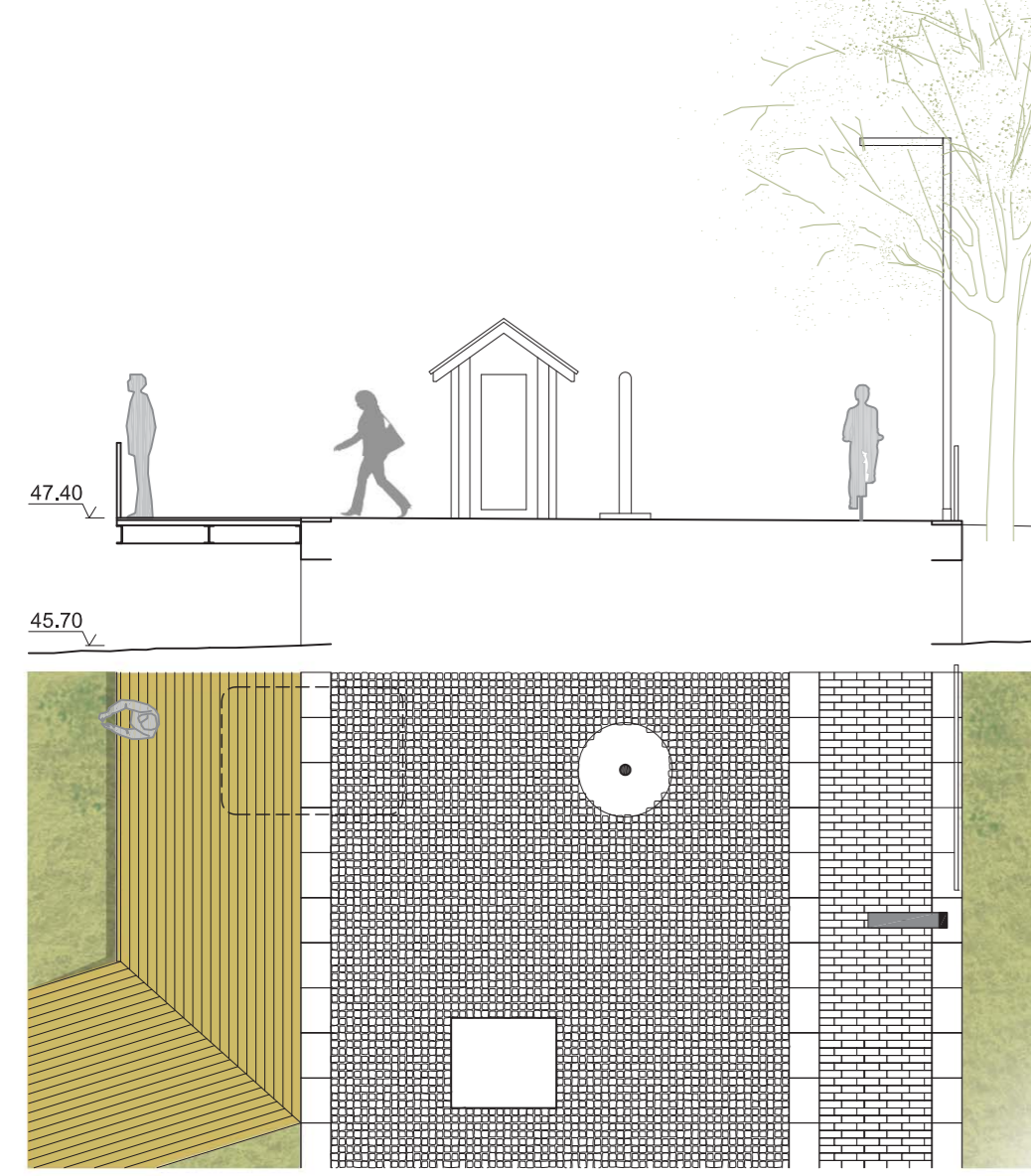

Pedestrian Street at the Border Crossing

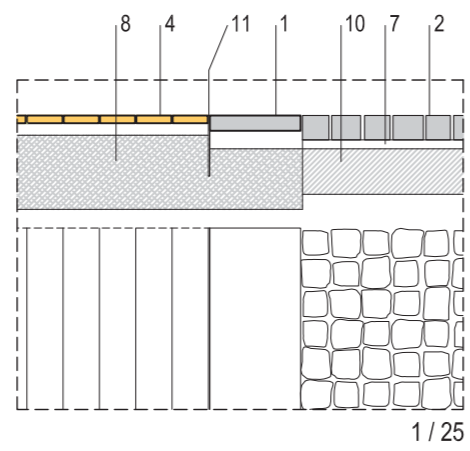

1. Granite stone pavers
2. Granite cobblestone
4. Wooden floor footbridge on battens
7. River washed sand bedding 4cm thick
8. Compacted soil
9. Mortar bedding 3cm thick
10. Concrete base 15cm thick
11. Galvanized steel plate 10mm thick & 20cm deep

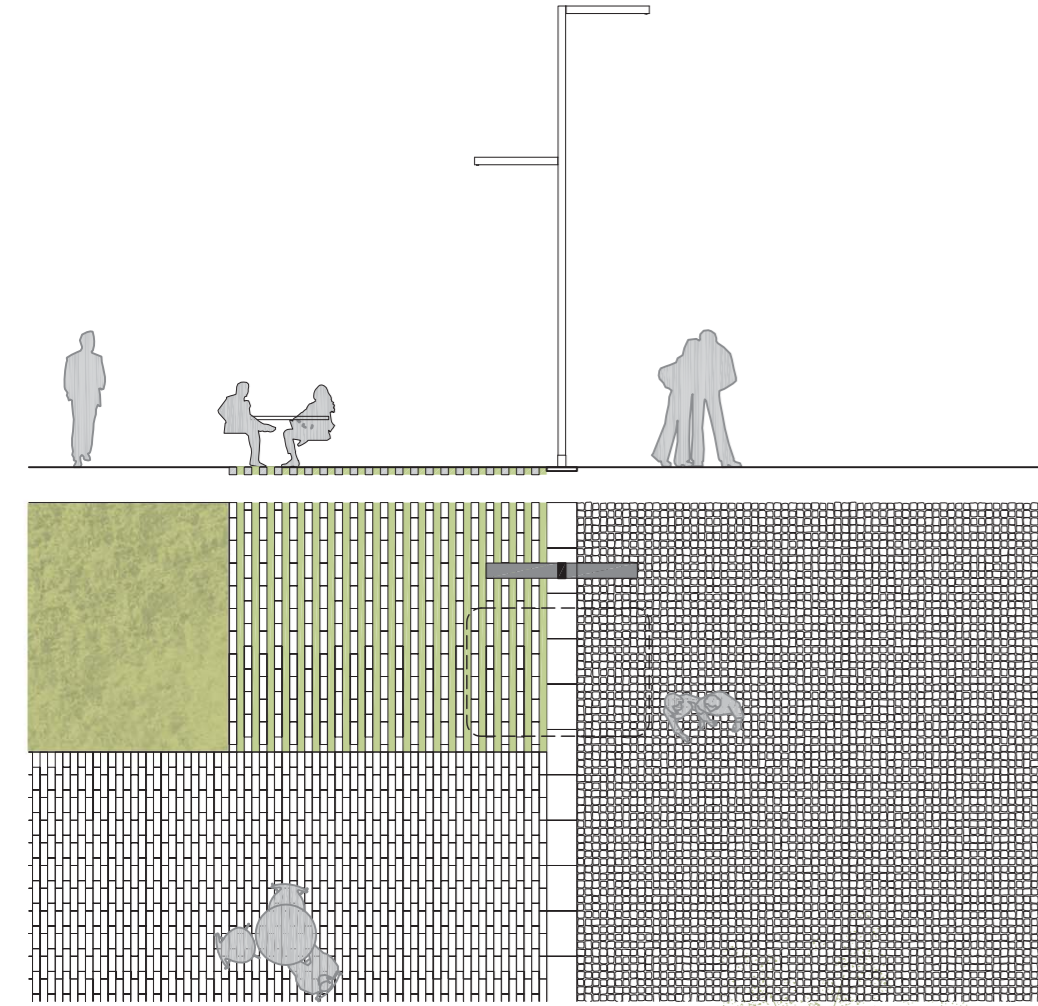

Pedestrian Street and the Plaza

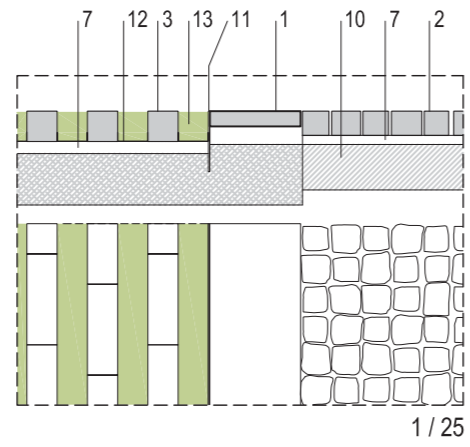

1. Granite stone pavers
2. Granite cobblestone
3. Precast concrete paver 10x30x10cm
7. River washed sand bedding 4cm thick
8. Compacted soil
9. Mortar bedding 3cm thick
10. Concrete base 15cm thick
11. Galvanized steel plate 10mm thick & 20cm deep
12. Galvanized spacer in U shape directly placed on the soil
13. Gaps filled with topsoil and grass

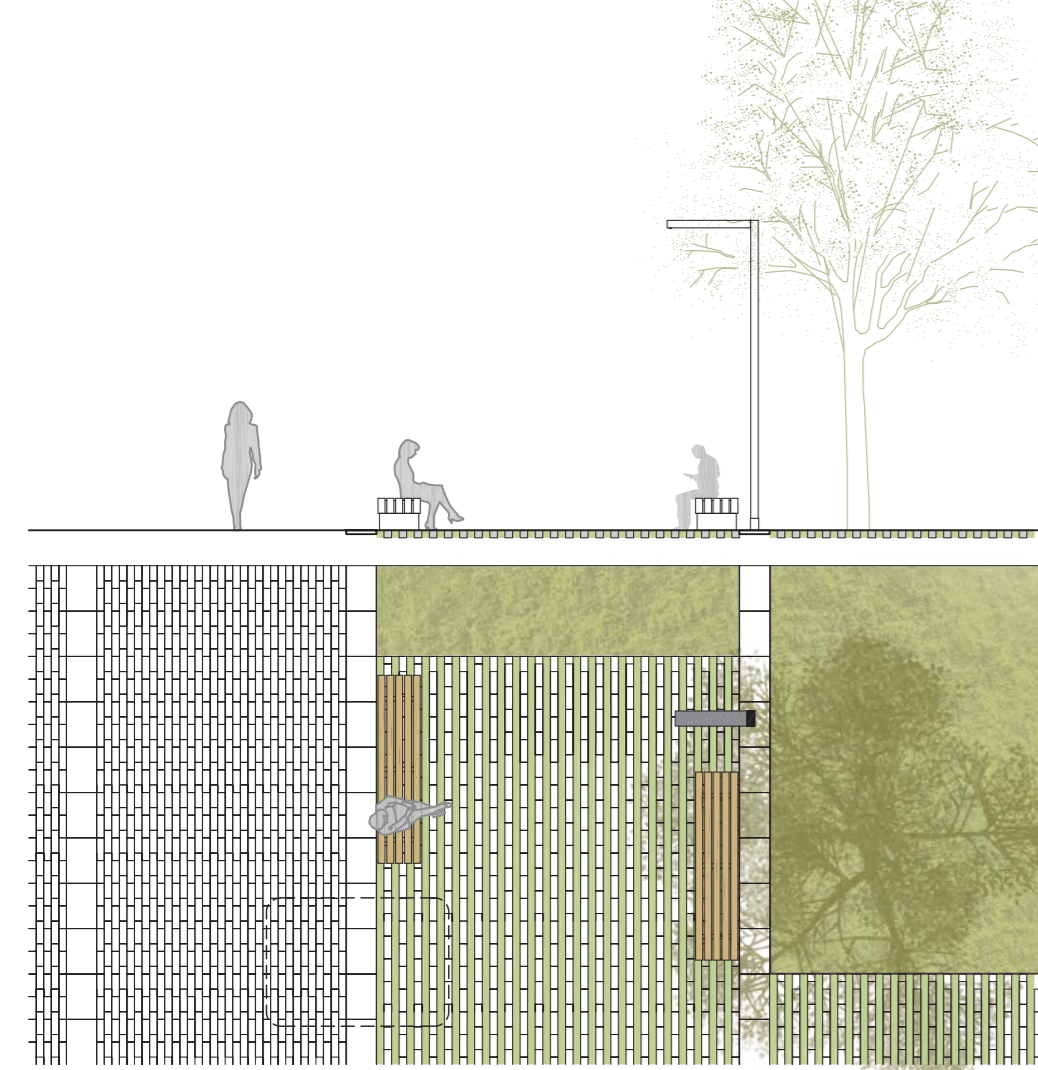

Seating areas on the Plaza

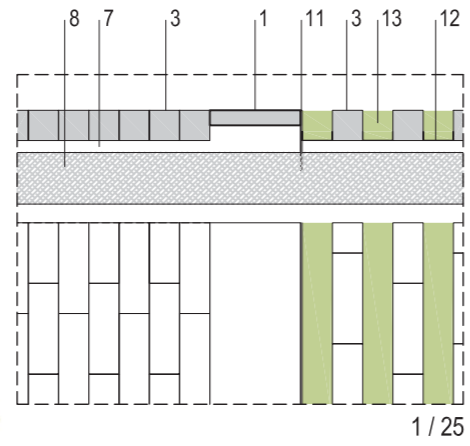

1. Granite stone pavers
3. Precast concrete paver 10x30x10cm
4. Wooden floor footbridge on battens
7. River washed sand bedding 4cm thick
8. Compacted soil
11. Galvanized steel plate 10mm thick & 20cm deep
12. Galvanized spacer in U shape directly placed on the soil
13. Gaps filled with topsoil and grass

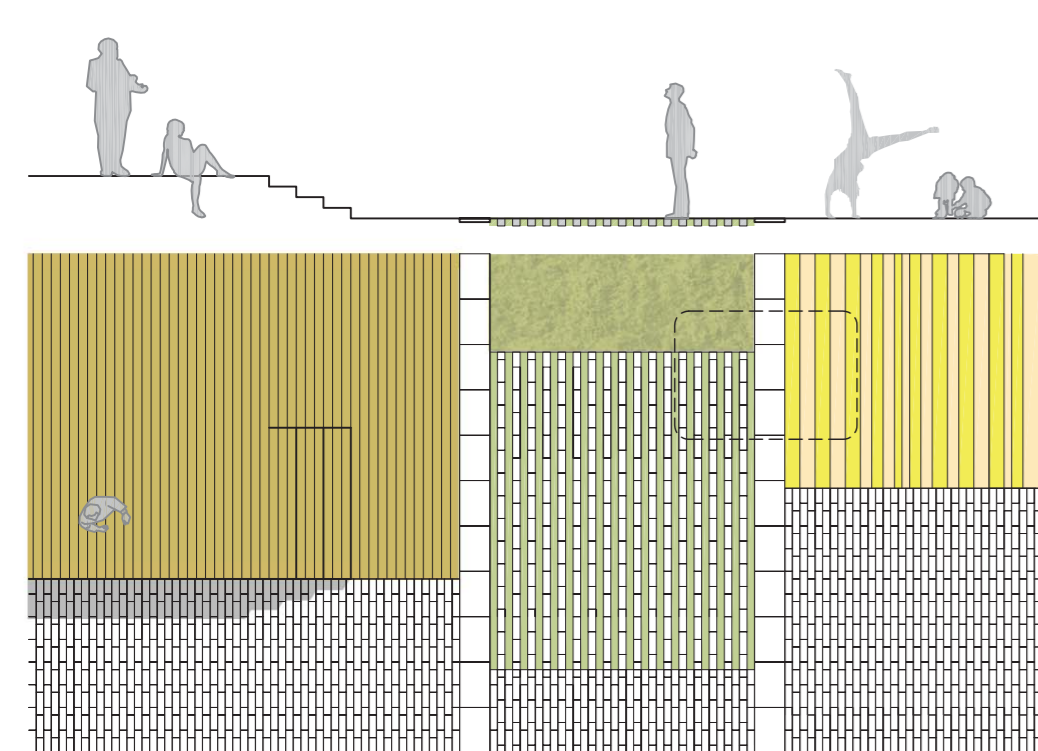

Children's playground & Stage

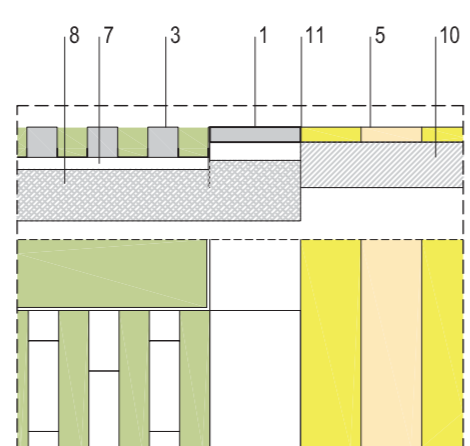

1. Granite stone pavers
3. Precast concrete paver 10x30x10cm
5. Colored Rubber floor 3cm thick minimum
7. River washed sand bedding 4cm thick
8. Compacted soil
9. Mortar bedding 3cm thick
10. Concrete base 15cm thick
11. Galvanized steel plate 10mm thick & 20cm deep
12. Galvanized spacer in U shape directly placed on the soil
13. Gaps filled with topsoil and grass

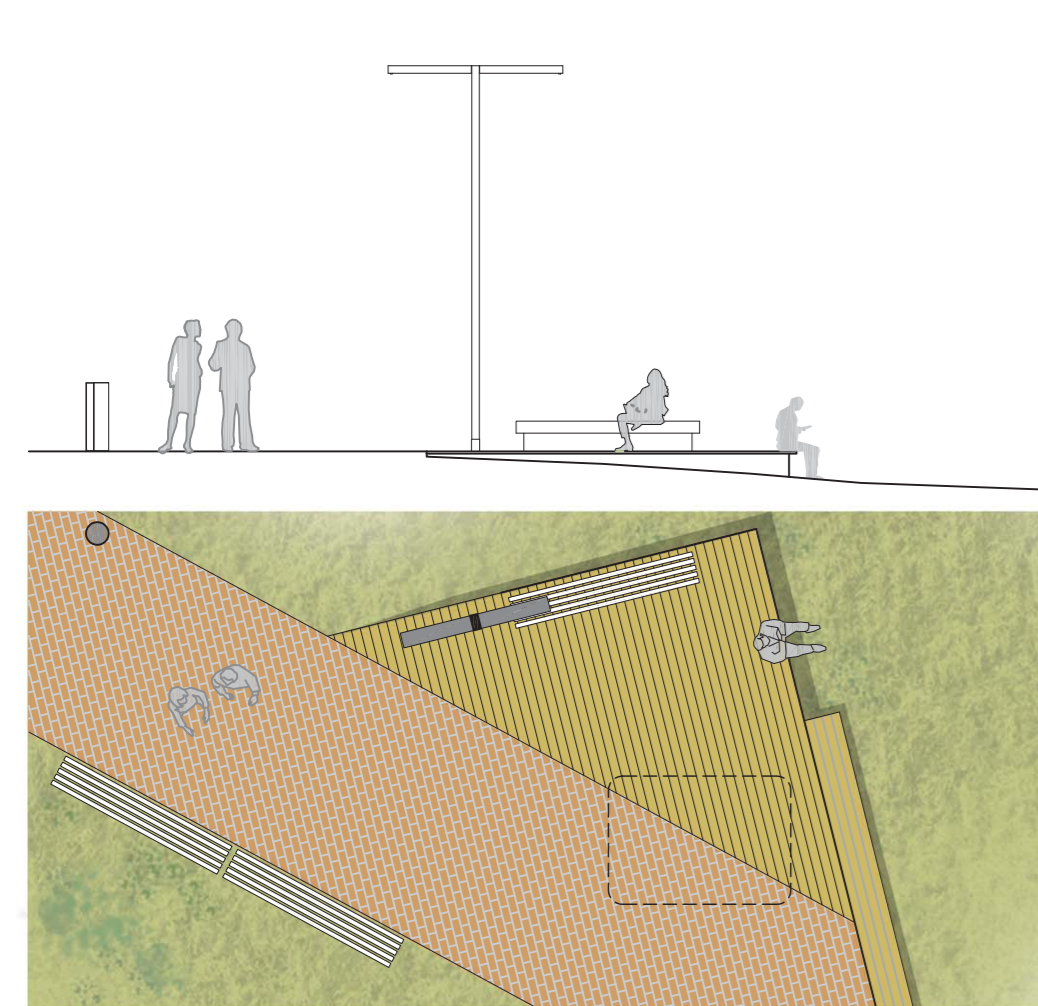

Passageways on the Creek Park

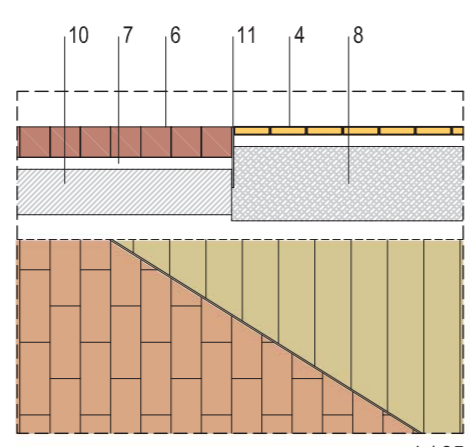

4. Wooden floor footbridge on battens
6. Brick pavement
7. River washed sand bedding 4cm thick
8. Compacted soil
10. Concrete base 15cm thick
11. Galvanized steel plate 10mm thick & 20cm deep

